

REV.	NOTES	DATE
A	RELEASED	2017/08/12

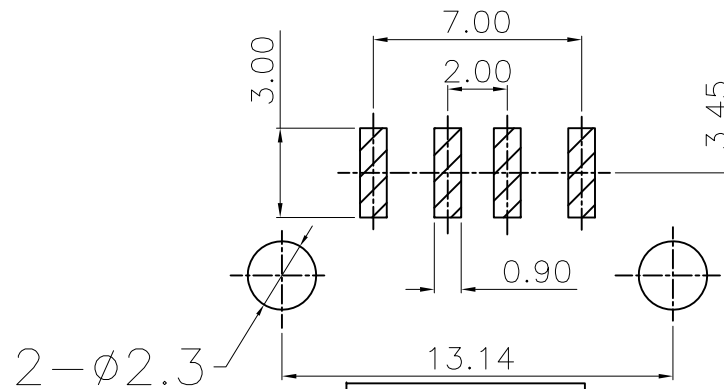
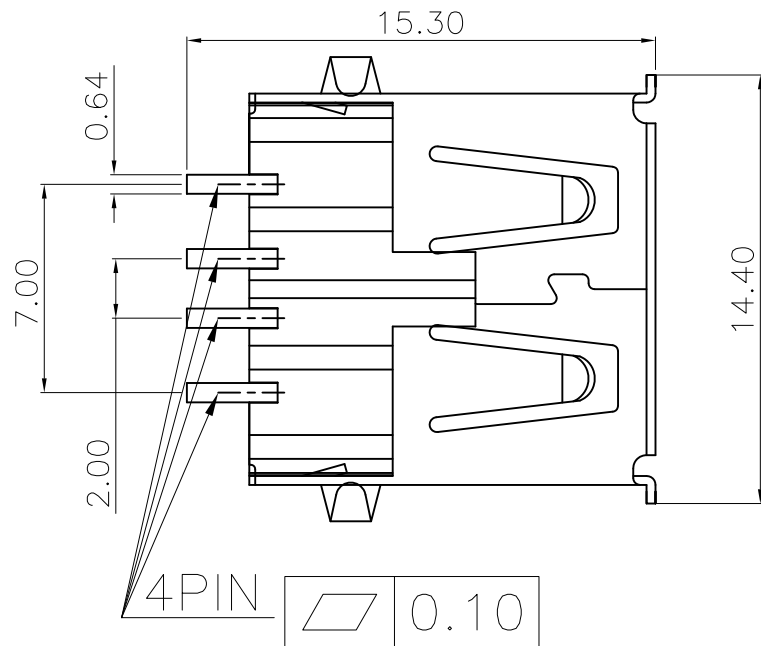
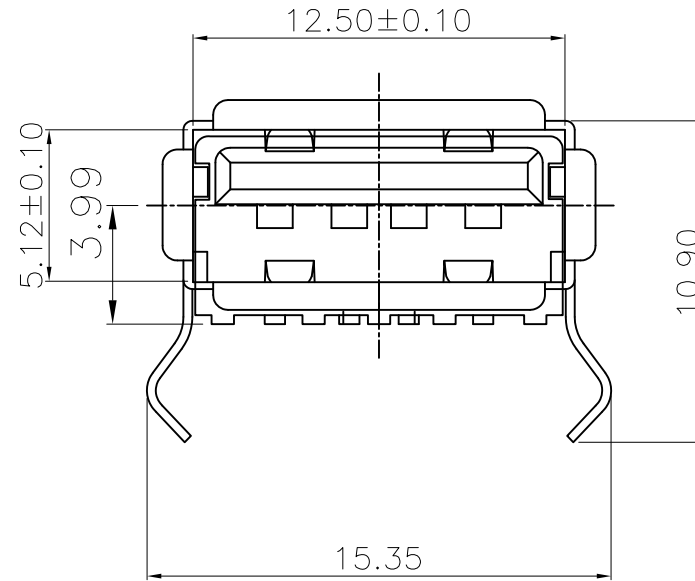
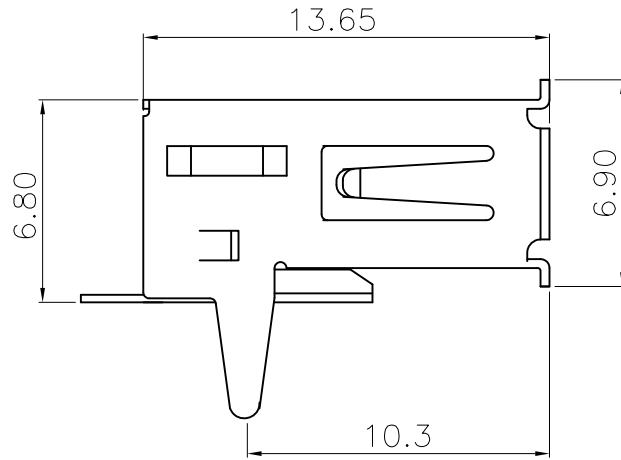

PCB.LAYOUT

NOTES:

- MATERIAL:
 - Housing:LCP BLACK;
 - terminals:Copper Alloy
Gold plated in contact area;
Tin plated in termination
Nickel Plated overall
 - Shell:Steel
Nickel Plated overall
- ELECTRICAL CHARACTERISTICS:
 - Rating Current :1.5 Ampere
 - Rating Voltage :30 V Max
 - Contact Resistance:30 Milli ohms
 - Insulation Resistance:1000 Mega ohms Min.
- MECHANICAL CHARACTERISTICS:
 - Connector Mating force: 35N MAX(3.57Kgf)
 - Connector Unmating force:10N min(1.02Kgf)
 - Durability:1500Cycles.
- ENVIRONMENT CHARACTERISTICS:
 - Operating temperature:-0℃ to +50℃
 - Storage temperature:-20℃ to +60℃

單位(UNITS)	mm	東莞翊豐精密五金有限公司							
數量(QT'Y)	N/A								
材料(MT'L)	SEE NOTE								
處理(FINISH)	SEE NOTE								
		圖名(NAME)							
繪圖(DRAW)		USB AF T型SMT弯脚无盖							
設計(DE'N)		料號(PART NUMBER)		AAUS+US04P-032X					
審校(CH'K)		圖號(DRAW NUMBER)							
		圖檔(FILE NAME .DWG)							
核准(APP'D)		比例 (SCALE)	1/1	圖紙 (SIZE)	A4	頁次 (SHEET)	1	版次 (REV.)	A

DIMENSIONS TOLERANCE METRIC

X :±0.5
 X.X :±0.30
 X.XX :±0.20
 ANGLES
 X :±1°
 X.X :±0.5°