

REV.	NOTES	DATE
A	RELEASED	2017/09/28

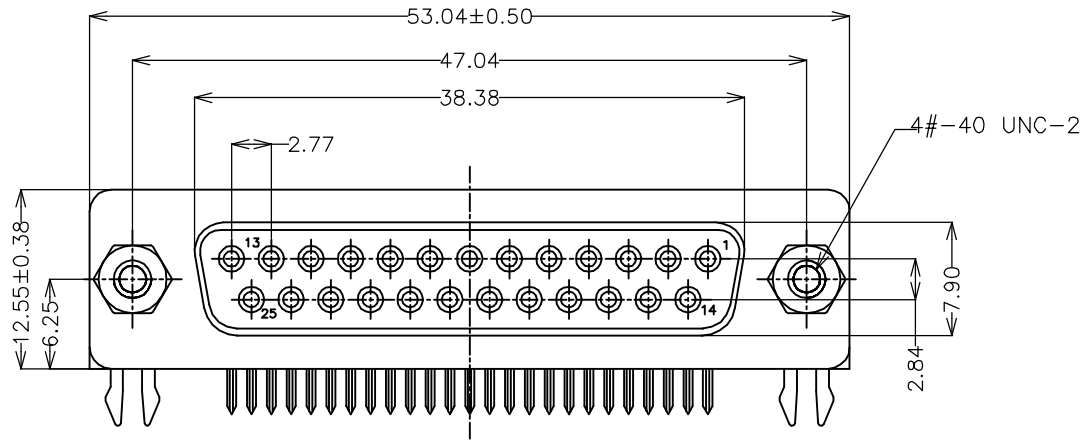

MATERIALS AND FINISH:
 SHELL:STELL MATERIAL,FONT SHELL NICKEL FINISHED,
 BACK SHELL TIN FINISHED;
 INSULATOR:PBT THERMOPLASTIC,30% GLASS FILLED,UL94V-0
 RATED,BLACK: COLOR;
 CONTACT MATERIAL:BRASS
 CONTACT FINISH: COLD FLASH /TIN
 RIVETED INSERT: BRASS MATERIAL,NICKEL FINISHED

ELECTRICAL CHARACTERISTICS:
 CONTACT CURREN T RATING:5.0 AMPS
 CONTACT RESISTANCE:30 MILLIOHMS MAX.
 DIELECTRIC WITHSTANDING VOLTAGE:1000 V AC MIN.
 INSULATION RESISTANCE:5000 MEGAOHMS MIN.
 TEMPERATURE RATING:-55°C~+105°C

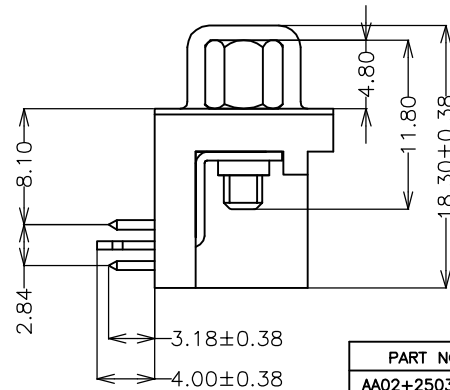
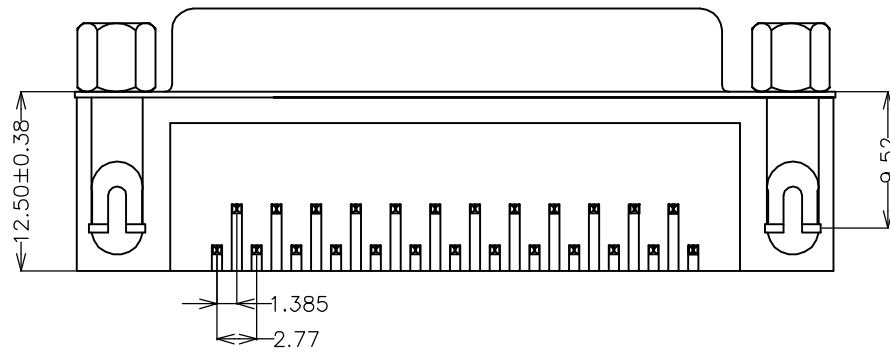

PART NO.	PLATING	COLOR
AA02+2503-2080	GOLD/TIN PLATED	BLACK

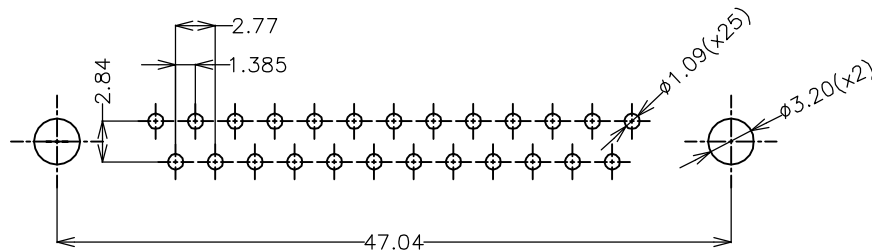

P.C.B. LAYOUT(TORANCE±0.05)
 TOP VIEW

DIMENSIONS TOLERANCE
METRIC
.0= ±.38
.00= ±.25
.000= ±.15
.0000= ±.
ANG.= ±2'

單位(UNITS)	mm
數量(QT'Y)	N/A
材料(MT'L)	SEE NOTE
處理(FINISH)	SEE NOTE
繪圖(DRAW)	
設計(DE'N)	
審校(CH'K)	
核准(APP'D)	

東莞翊豐精密五金有限公司			
圖名(NAME) DR25母又鎖半金黑8.1 RoHS			
料號(PART NUMBER)		AA02+2503-2080	
圖號(DRAW NUMBER)			
圖檔(FILE NAME .DWG)			
比例(SCALE)	1/1	圖紙(SIZE)	A4
頁次(SHEET)	1	版次(REV.)	A