

REV.	NOTES	DATE
A	RELEASED	2017/09/08

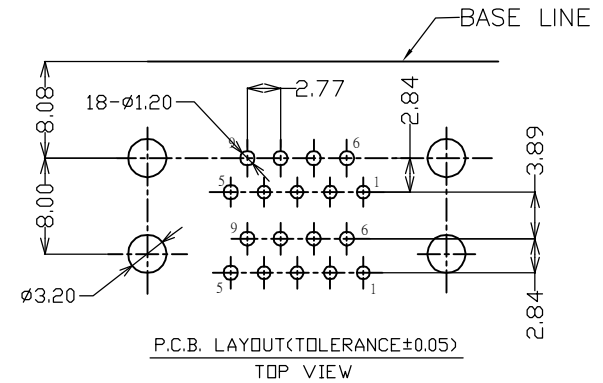

- MATERIAL:
 - HOUSING: PBT+GF30%,UL94V-0, BLACK
 - CONTACT: COPPER ALLOY
 - SHELL: SPCC
- FINISH:
 - SHELL: NICKEL PLATED 30u" Min.
 - CONTACT: GOLD PLATED IN CONTACT AREA 0.6u" Min, TIN PLATED IN SOLDER AREA 80u" Min. and 30u" Min NICKEL UNDER PLATED ALL OVER.
 - BOARD LOCK: TIN PLATED 80u" Min.
 - SQUARE RIVET: NICKEL PLATED 30u" Min.
 - SHELL BRACKET: NICKEL PLATED 30u" Min.
- ELECTRICAL CHARACTERISTICS:
 - RATED CURRENT: 3 AMP MAX
 - RATED VOLTAGE: 30V DC
 - INSULATION RESISTANCE: 1000M OHMS MIN. AT 500V
 - CONTACT RESISTANCE: 30m OHMS MAX.
 - DIELECTRIC WITHSTANDING VOLTAGE: 1000V AC FOR ONE MINUTE
 - OPERATING TEMPERATURE: -45°C TO +85°C

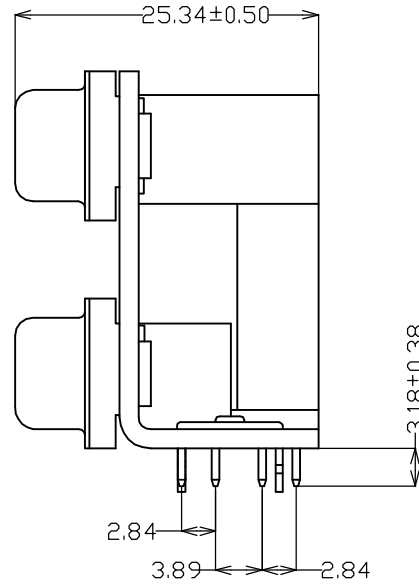
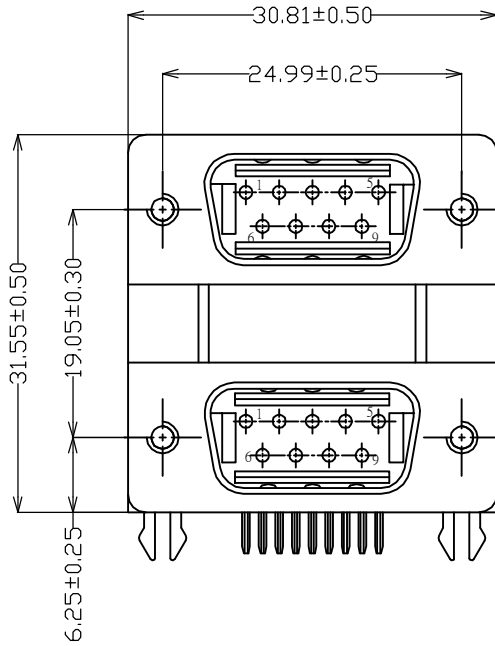
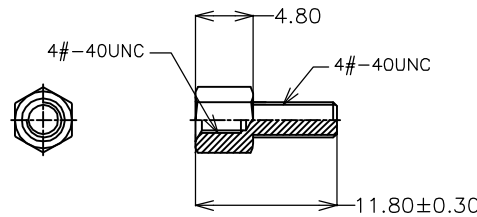
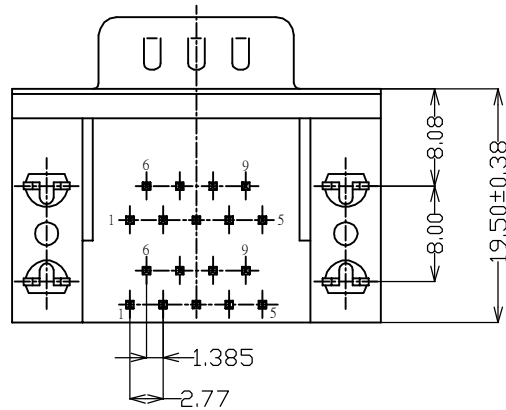

DIMENSIONS TOLERANCE
METRIC
 .0= ±.38
 .00= ±.25
 .000= ±.15
 .0000=±
 ANG.= ± 2'

單位(UNITS)	mm
數量(QTY)	N/A
材料(MTL)	SEE NOTE
處理(FINISH)	SEE NOTE

東莞翊豐精密五金有限公司 圖名(NAME) 9公雙層附鉚半金黑8.1 L單形支架19.05 RoHS							
料號(PART NUMBER)				AA20+9191-4208L2			
圖號(DRAW NUMBER)							
圖檔(FILE NAME .DWG)							
比例(SCALE)	1/1	圖紙(SIZE)	A4	頁次(SHEET)	1/2	版次(REV.)	A