

REV	NOTES	DATE
A	初版發行	2017/07/21
B	修改成3A	2017/09/26

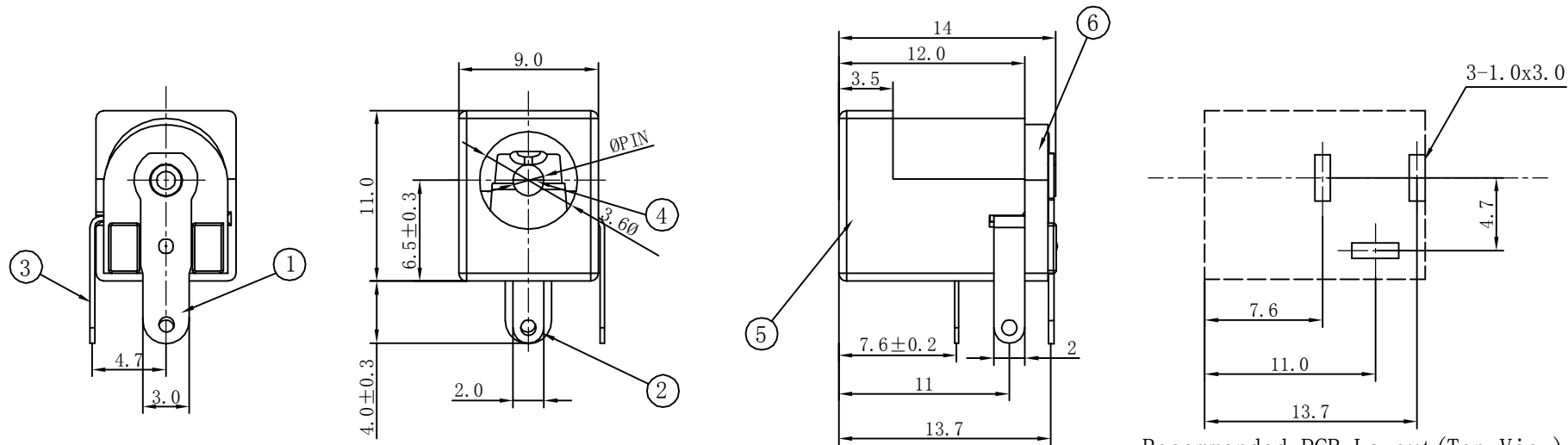

Recommended PCB Layout (Top View)
General tolerance: ±0.05

Part No:	Dim. Pin
AAPJ+0545-20Z2S0	Ø2.0
AAPJ+0545-20Z2S1	Ø2.5

SPECIFICATIONS:

- ELECTRICAL CHARACTERISTICS:
 - RATING: DC30V 3A
 - CONTACT RESISTANCE: 30mΩ MAX.(INITIAL)
 - DIELECTRIC WITHSTANDING VOLTAGE: 500V AC FOR ONE MINUTE
 - INSULATION RESISTANCE: 100MΩ MIN. MEASURED BY 250V DC
- MECHANICAL CHARACTERISTICS:
 - INSERTION FORCE : 0.3~3.0 KGF
 - WITHDRAWAL FORCE : 0.3~3.0 KGF
- LIFE TEST: 5,000 CYCLES MIN.
- Operation temperature: -16~65°C.

6	蓋板	1PCS	PBT	黑色
5	底座	1PCS	PBT	黑色
4	插針	1PCS	Brass H65	Tin plated
3	靜觸片	1PCS	Brass H65 t=0.50	Ag plated
2	動觸片	1PCS	phosphor Bronze t=0.30	Ag plated
1	插針腳	1PCS	Brass H65 t=0.40	Ag plated
No.	Part name	QYT	Material	Remark

DIMENSIONS TOLERANCE METRIC
.0= ±.30
.00= ±.25
.000= ±.02
.0000= ±.01
ANG.= ±1°

單位(UNITS)	mm	東莞翊豐精密五金有限公司			
數量(QT'Y)	N/A	圖名(NAME) DC POWER JACK Ø6.3 PINØ2.0與Ø2.5			
材料(MT'L)	SEE NOTE				
處理(FINISH)	SEE NOTE	料號(PART NUMBER)		AAPJ+0545-20Z2SX	
繪圖(DRAW)		圖號(DRAW NUMBER)		RAAAPJ0545	
設計(DE'N)		圖檔(FILE NAME .DWG)			
審核(CH'K)		比例(SCALE)	1/2	圖紙(SIZE)	A4
核准(APP'D)		頁次(SHEET)	1	版次(REV.)	A