

REV.	NOTES	DATE
A	RELEASED	2023/05/05
B	調整圖面尺寸公差	2023/06/14
C	依客戶圖調整圖面尺寸與公差	2023/11/10

NOTES:

- MATERIAL:
 - HOUSING: LCP, 30% GLASS FIBER FILLED UL94V-0 RATED. COLOR-BLACK.
 - TERMINAL PIN: C5191, T=0.25±0.02mm
 - SHELL: BRASS, T=0.30±0.02mm
 - MIDDLE SHELL: SUS 201, T=0.30±0.02mm
- FINISH:
 - TERMINAL PIN: GOLD FLASH ON CONTACT AREA. 100μ*(Min), BRIGHT TIN PLATED ON SOLDER TAILS. 50μ*(Min), NICKEL UNDER PLATING OVER ALL.
 - SHELL: NICKEL PLATED.
- DATE CODE: XXXXX

WEEK: 001~053
YEAR: 23=2023

DATE CODE

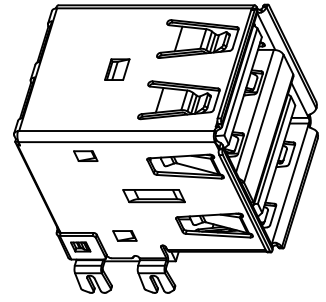
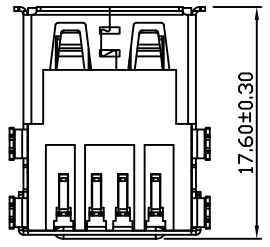
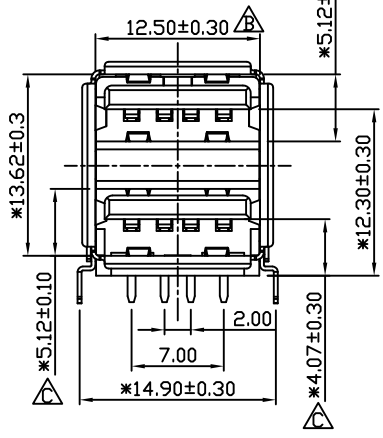
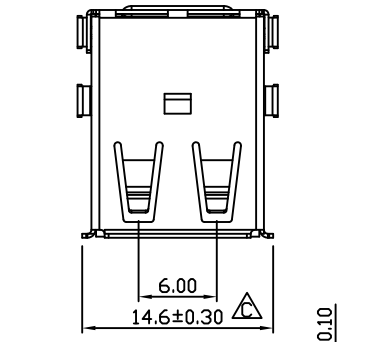
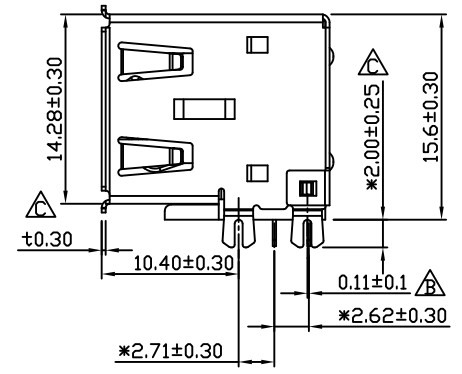
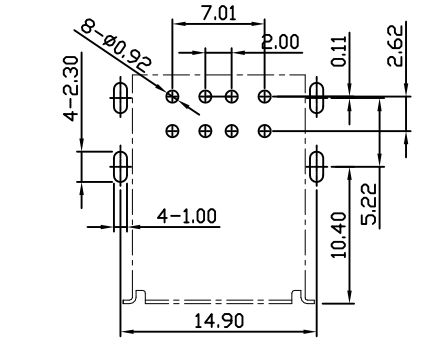
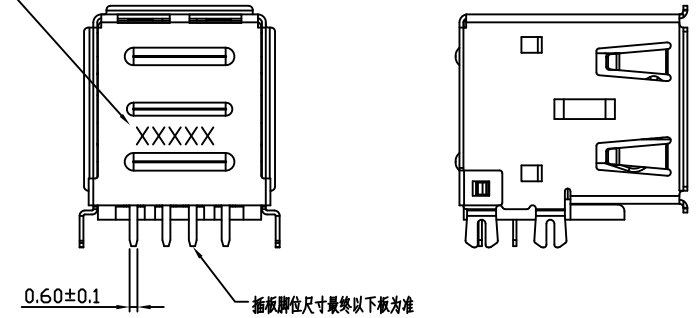

NO	DESCRIPTION	QTY	MATERIAL	PLATING & COLOR
D	MIDDLE SPRING	1	SUS201	NO PLATED
C	SHELL	1	C2680	NI 50u" min
B	CONTACT	8	C5191	Gold flash CONTACTAREA 100u" min Bright Tin on solder tails Ni 50u" min Under plating over all
A	HOUSING	1	THERMOPLASTIC	LCP BLACK

單位(UNITS)	mm
數量(QTY)	N/A
材料(MT'L)	SEE NOTE
處理(FINISH)	SEE NOTE
繪圖(DRAW)	

東莞翊豐精密五金有限公司

圖名(NAME)
USB 2.0 AF 双层90度四脚插板后盖连体型

料號(PART NUMBER) AUS+UA2244+BS21

圖號(DRAW NUMBER) RAAUSUA2244BS21

圖檔(FILE NAME) .DWG

GENERAL TOLERANCE
X. = ±
.X = ±.30
.XX = ±.10
.XXX = ±.05
ANG. = ±1°

設計(DE'N)

審校(CH'K)

核准(APP'D)

比例(SCALE)	1:1	圖紙(SIZE)	A4	頁次(SHEET)	1	版次(REV.)	C
-----------	-----	----------	----	-----------	---	----------	---