

REV.	NOTES	DATE
A	RELEASED	2021/04/07

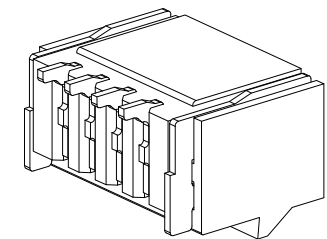

Specifications:

- Contact resistance: ≤20mΩ
- Insulation resistance: ≥100MΩ
- Rated voltage: 50V AC DC
- Rated current: 1.0A AC DC \square
- Withstand voltage: 500V AC/minute
- Temperature range: -25°C ~ +105°C
- Housing: LCP UL94V-0, Natural
- Contacts: Phosphor bronze (Matte sn/Gold plating)
- Solder tabs: Phosphor bronze/Matte sn

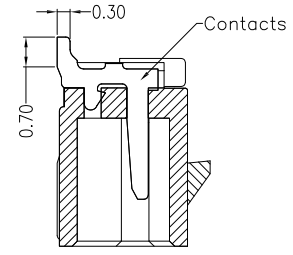
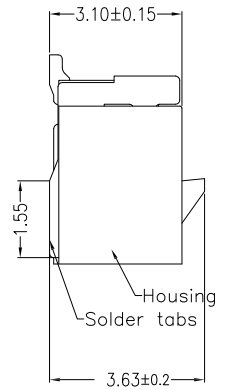
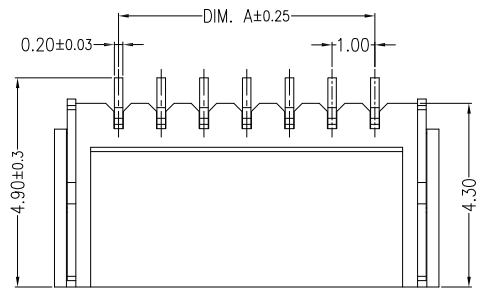
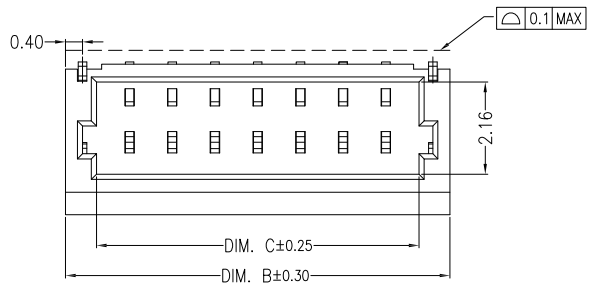

AABT + XXS1-A110

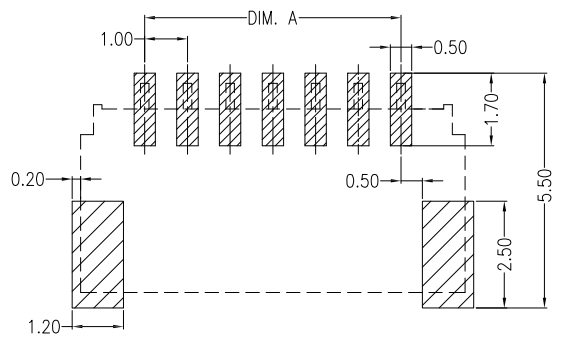
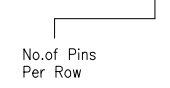

Recommend PCB Layout

Circuit	Dimensions (mm)		
	DIM. A	DIM. B	DIM. C
02	1.00	4.00	2.45
03	2.00	5.00	3.45
04	3.00	6.00	4.45
05	4.00	7.00	5.45
06	5.00	8.00	6.45
07	6.00	9.00	7.45
08	7.00	10.00	8.45
09	8.00	11.00	9.45
10	9.00	12.00	10.45
11	10.00	13.00	11.45
12	11.00	14.00	12.45
13	12.00	15.00	13.45
14	13.00	16.00	14.45
15	14.00	17.00	15.45
16	15.00	18.00	16.45
20	19.00	22.00	20.45

DIMENSIONS TOLERANCE METRIC

X : ±0.5
X.X : ±0.30
X.XX : ±0.25

ANGLES
X : ±1°
X.X : ±0.5°

單位(UNITS)	mm	東莞翊豐精密五金有限公司					
數量(QU'TY)	N/A						
材料(MT'L)	SEE NOTE						
處理(FINISH)	SEE NOTE	圖名(NAME)					
繪圖(DRAW)		Wafer PH1.00mm 90° 卧贴LCP米白色鍍錫 ROHS					
設計(DE'N)		料號(PART NUMBER)			AABT+XXS1-A110		
		圖號(DRAW NUMBER)					
審校(CH'K)		圖檔(FILE NAME .DWG)					
		比例(SCALE)	1/1	圖紙(SIZE)	A4	頁次(SHEET)	1/2
核准(APP'D)							